

MINILink® System

DADCO's exclusive *MINILink®* System, an extremely compact piping system, can be used with DADCO's Micro Series and small **Ultra Force®** Series (U.0175/U.0325) Nitrogen Gas Springs. A *MINILink®* system consists of a *MINIFLEX®* hose, Mini-fitting, and a Mini Control Panel.



Micro C.180's shown linked to a 90.407.11G mini control panel.

MINIFLEX® Hose

90.700._____ (meters)

DADCO's *MINIFLEX®* hose is used to connect gas springs together in a linked system. DADCO offers complete hose assemblies that include two 90.601.943 Hose Adapters and a standard length of *MINIFLEX®* hose. Optionally, DADCO offers a 90.705 hose with a higher working pressure and burst pressure for Extreme Condition Applications; refer to Linked System Catalog (C09118C) for more information. Hose Assemblies can also be fabricated in the field with the use of DADCO's Mini-Crimp, 90.710.1 (see reverse).

WORKING PRESSURE	500 bar 7,250 psi
BURST PRESSURE	1890 bar 27,405 psi

.SS = Stainless Steel Option Available



Minimum recommended distance between sealing faces (L) = 75 (2.95)

90.700.L943.L943._____ **.I**
L (mm)
Hose Assembly

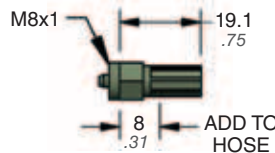

90.601.943 **.SS**
(L-943)
Permanent Hose Adapter

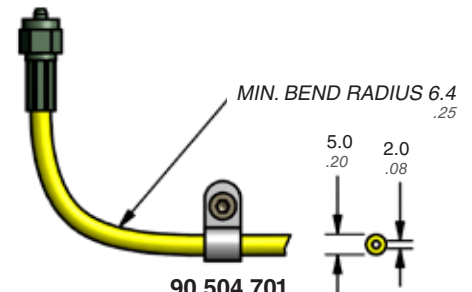

90.504.701
(HS-701)
Hose Strap

Micro and Ultra Force® Series Port Adapters

DADCO's 90.607.122 and 90.607.038 Series Port Adapters are designed specifically to work with DADCO's Micro and small **Ultra Force®** Series Nitrogen Gas Springs. **NOTE: Do not attempt to thread any Mini-fitting directly into the port.**

Linking the Micro or small Ultra Force® Series

1. Select the appropriate Micro or **Ultra Force®** Series Port Adapter, 90.607.122 or 90.607.038.
2. Thread the Port Adapter into the base of the Nitrogen Gas Spring. Tighten the Port Adapter by hand or use a wrench to tighten if necessary. Do not over torque Port Adapter during installation (*Torque Specification: 3N·m or 25 lb·in*).
3. Attach a 90.700 Hose Assembly to the Port Adapter. The gas spring is now ready for linked operation with DADCO's 90.407.11G Mini Control Panel or 90.407.PL Mini Convertible Control Panel.

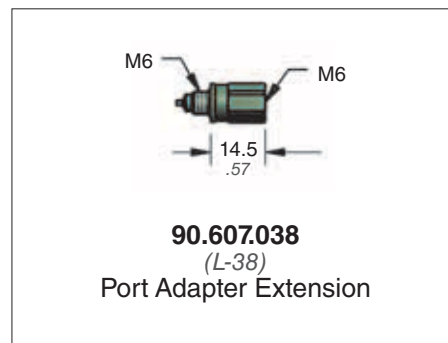
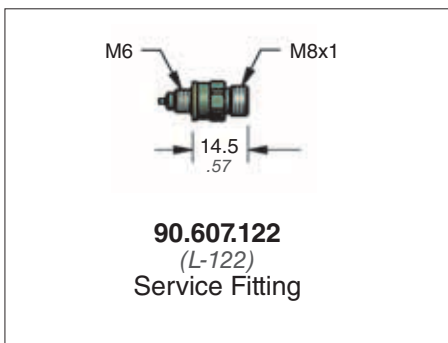

B03103D

**Micro Series and Small Ultra Force® Series
(U.0175/U.0325) Linked System**

Mini-fittings

DADCO provides numerous Mini-fittings to accommodate the specific needs of each system design.

- To reduce the number of fittings required, use as many direct runs as possible.
- Bend hose where possible. DADCO *MINIFLEX*® hose has a bend radius of 5 mm (.20").
- Connect the *MINIFLEX*® hose to a fitting by hand first, then tighten with a wrench for 2 flats only.

.SS = Stainless Steel Option Available

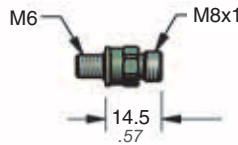

90.607.120 .SS
(L-120)
Straight Port Adapter

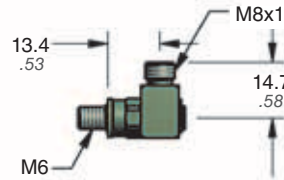

90.607.220 .SS
(L-220)
90° Port Adapter

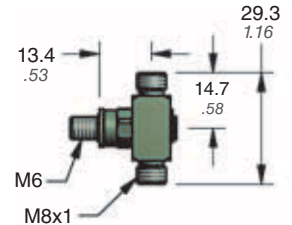

90.607.429 .SS
(L-429)
Branch Tee Port Adapter

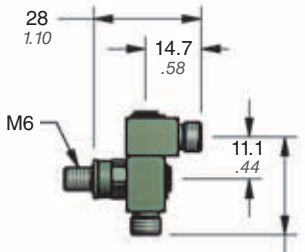

90.607.428
(L-428)
Run Tee Port Adapter

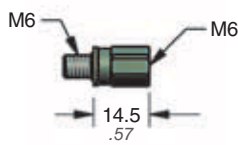

90.607.035
(L-35)
Port Adapter Extension

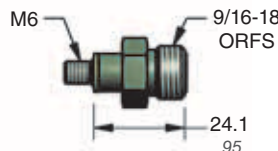

90.505.116
(S-116)
Reducer
M6 → 9/16-18

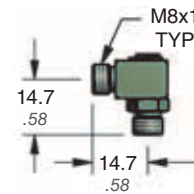

90.607.201
(L-201)
Elbow

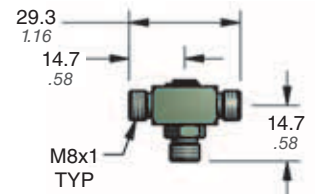

90.607.401
(L-401)
Union Tee

Torque Specifications:
3N-m or 25 lb-in

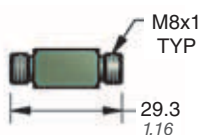

90.606.303
(L-303)
Union

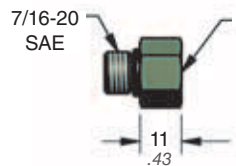

90.607.055
(L-55)
Reducer
7/16-20 → M6

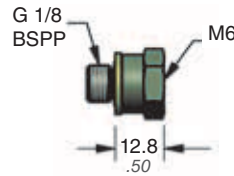

90.607.065
(L-65)
Reducer
G 1/8 → M6



90.607.115
(L-115)
Reducer
G 1/8 → M8x1

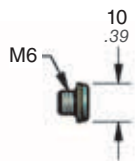

90.607.110
(L-110)
Port Plug



90.605.109
(L-109)
Fitting Plug

M6 → G 1/8 Port Adapters

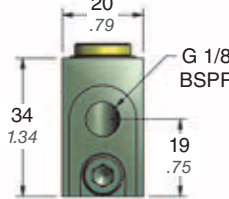
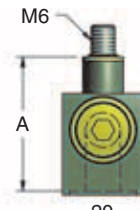

Straight

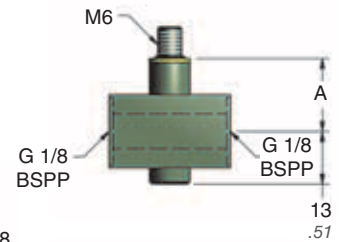

Branch Tee

Part No.	A
90.607.116	33 1.30
90.607.126	46 1.81

Part No.	A
90.607.439	18 .71
90.607.449	31 1.22

Mini-Crimp 90.710.8

Used in a crimping machine to construct hose assemblies using 90.700 / 90.705 (Y-700 / Y-705) hose. For more information, request bulletin B00106A.

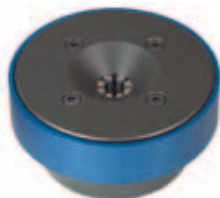

Mini Control Panels

Used to fill, drain and monitor the pressure of linked Micro and small U Series Nitrogen Gas Springs from outside of the die. The panels consist of a high pressure gauge, quick disconnect fill valve, a bleed valve, and a rupture disk to prevent overpressuring. Refer to Linked System Components Catalog (C09118C) for more information.



90.407.11.G



90.407.PL

B03103D