

Pad Bounce Reducer

Pad Bounce Reducer

DADCO's Pad Bounce Reducer dampens pad bounce resulting from inertia of the lower pad on the return stroke. The lower pad is stabilized by locating a minimum of four Pad Bounce Reducers at the corners of the die shoe around the pad. Once the pad returns to home position, the bounce is minimized, improving the placement of the stamped part. DADCO's Pad Bounce Reducer may be used to replace traditional keepers. When designing, verify upper die clearance is sufficient for gas springs.



BR.2100

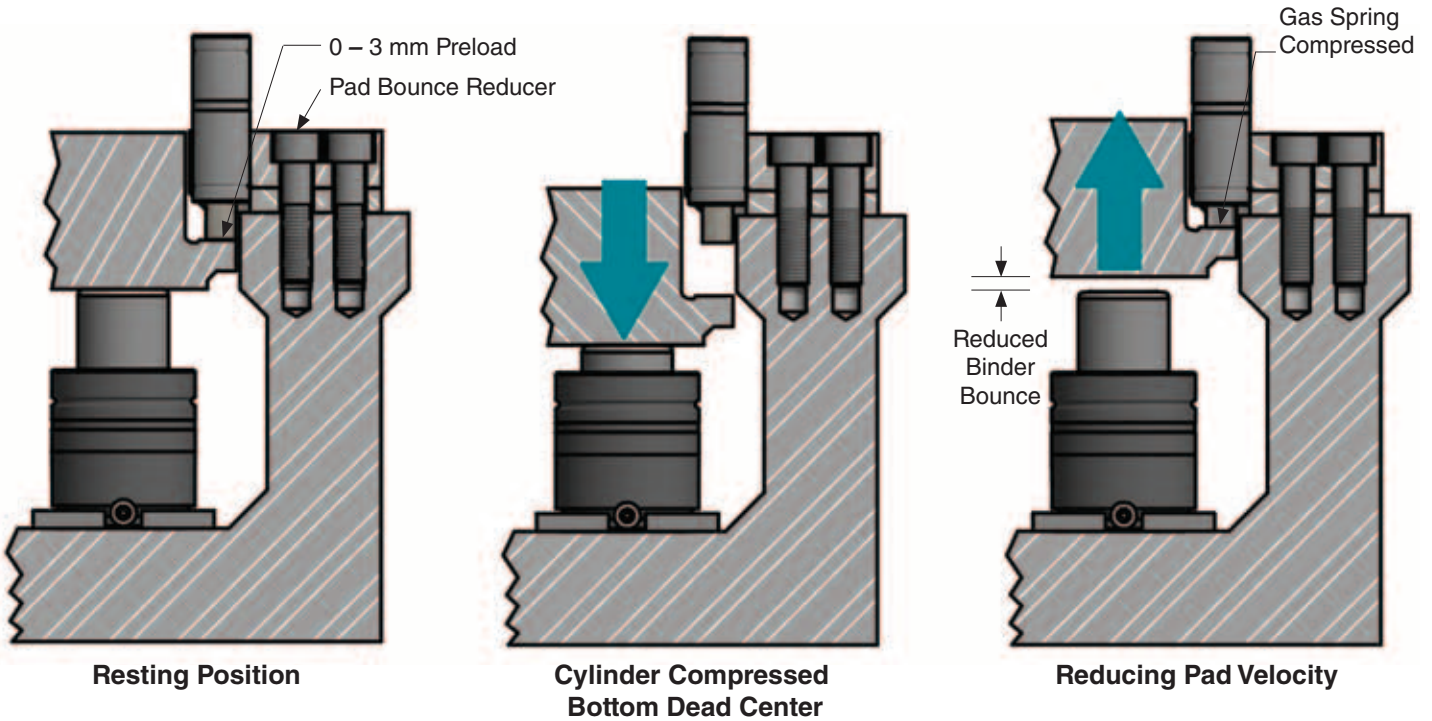

Technical Data

A binder bounce reduction of 50% will be achieved for the corresponding Bounce Reducer model and Binder Weight, shown in the table below. If the binder weight/mass is less than the number shown, the reduction is greater. This data assumes that four units are used on the corners of the binder or draw ring.

Charging Pressure psi bar	BR.1300		BR.2100 and BR.7032		BR.3300		BR.4700	
	Force lb kN	Binder Mass lb-mass kg-mass	Force lb kN	Binder Mass lb-mass kg-mass	Force lb kN	Binder Mass lb-mass kg-mass	Force lb kN	Binder Mass lb-mass kg-mass
2175 150	1327 5.90	5300 2404	2115 9.41	8500 3856	3310 14.73	13,200 5988	4768 21.21	19100 8664
1813 125	1106 4.92	4400 1996	1762 4.92	7000 3175	2759 12.27	11,000 4990	3973 17.67	15900 7212
1450 100	885 3.93	3500 1588	1410 3.93	5600 2540	2207 9.82	8,800 3992	3178 14.14	12700 5761

B02107C

Pad Bounce Reducer

BR.1300, 2100, 3300 and 4700

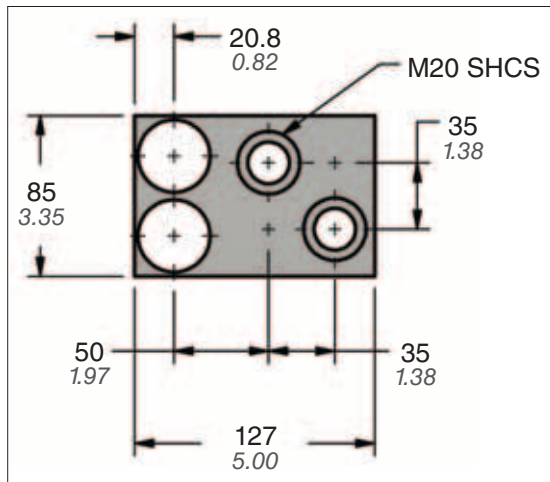

BR.7032

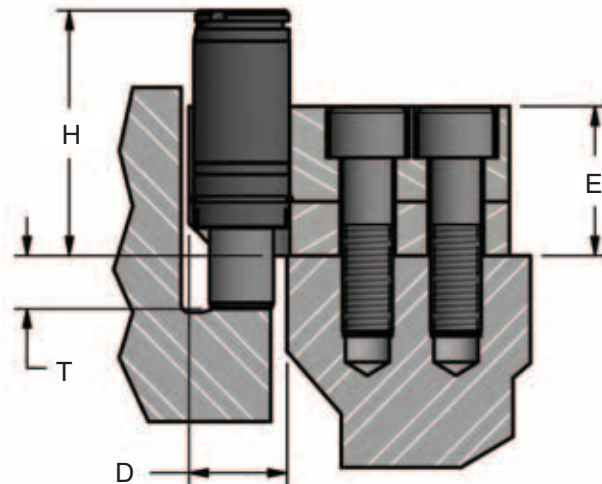
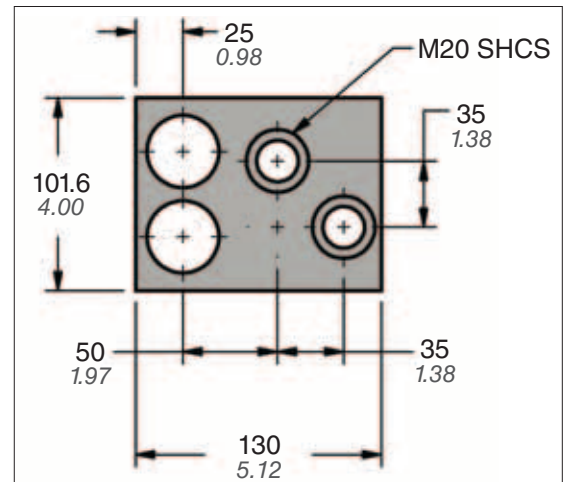

Part No.	Model Size				
	BR.1300	BR.2100	BR.3300	BR.4700	BR.7032 (WDX4 - 90)
D	36 1.42	36 1.42	40 1.58	40 1.58	40 1.58
E	59 2.32	59 2.32	59 2.32	54 2.13	55 2.17
H	73 2.87	72 2.83	97 3.82	142 5.59	68.5 2.70
T	23 0.91	22 0.87	21 0.83	25 0.98	27.5 1.08
Gas Springs (2) per unit	LJ.300.032.TO	U.0600.032.TO	SCR.0800.032.TO	SC.01000.032.TO	U.0600.032.TO

Ordering Example:

Please note; a set of four bounce reducers is required per die.

Part Number: BR.2100. 150
Includes Series and Model

Charging Pressure:
100-150 bar (1450-2175 psi)
When not specified, default is 150 bar.